

**SPINNING REEL RS 2600**

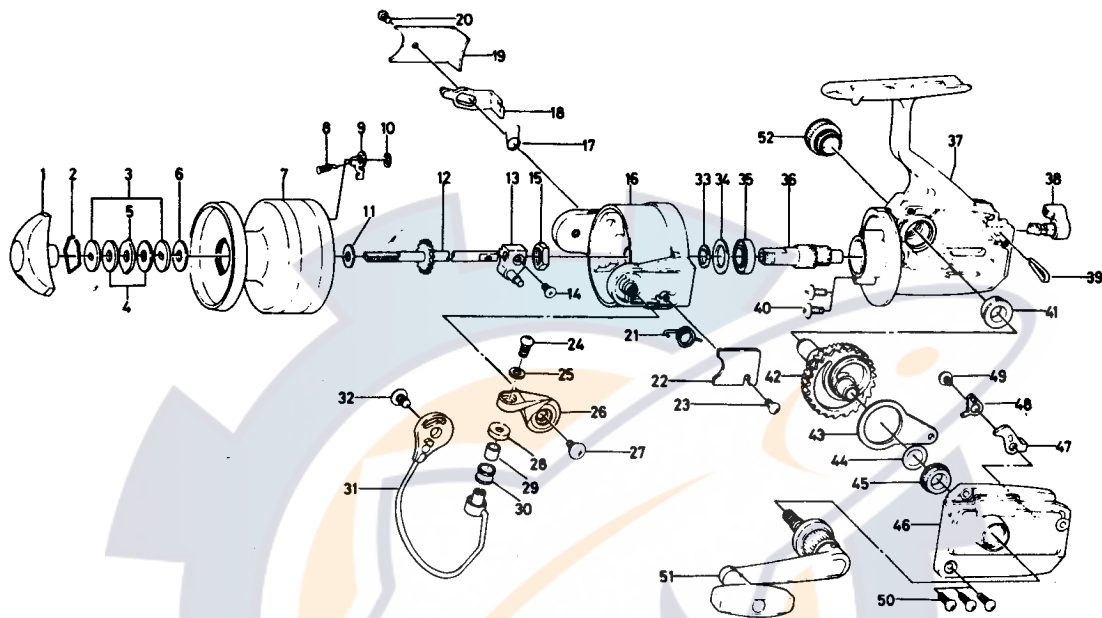

| Key No. | Parts No. | Parts Name                  |
|---------|-----------|-----------------------------|
| 1       | 740-2103  | Drag knob                   |
| 2       | 170-4001  | Drag washer retainer        |
| 3       | 373-2502  | Drag D washer               |
| 4       | 374-2901  | Disc washer                 |
| 5       | 375-5301  | Drag A washer               |
| 6       | 370-6901  | Drag washer A               |
| 7       | 734-1702  | Spool                       |
| 8       | 145-2101  | Spool click claw spring     |
| 9       | 807-8201  | Spool click claw            |
| 10      | 320-1402  | Spool click claw retainer   |
| 11      | 374-9001  | Spool washer                |
| 12      | 850-9601  | Main shaft                  |
| 13      | 637-3002  | Oscillating support         |
| 14      | 351-8901  | Oscillating support screw   |
| 15      | B10-5701  | Rotor nut                   |
| 16      | B19-7102  | Rotor                       |
| 17      | B18-4701  | Bail kick lever spring      |
| 18      | B19-7501  | Bail kick lever             |
| 19      | B19-7601  | Bail kick lever cover       |
| 20      | 352-0401  | Bail kick lever cover screw |
| 21      | B19-7201  | Bail spring                 |
| 22      | B19-7401  | Bail spring cover           |
| 23      | 352-0401  | Bail spring cover screw     |
| 24      | B11-2802  | Bail screw                  |
| 25      | B11-2701  | Bail washer                 |
| 26      | B19-7301  | Arm lever                   |

Sold as one unit  
Spool assembly  
734-1603

| Key No. | Parts No. | Parts Name                |
|---------|-----------|---------------------------|
| 27      | 352-1102  | Arm lever screw           |
| 28      | 501-2001  | Roller collar             |
| 29      | 502-1401  | Sleeve                    |
| 30      | 250-4501  | Line roller               |
| 31      | B19-7701  | Bail                      |
| 32      | 352-1102  | Bail holder screw         |
| 33      | B50-9301  | Spacer                    |
| 34      | 847-9201  | Rotor washer              |
| 35      | B54-6001  | Ball bearing              |
| 36      | B50-9201  | Pinion gear               |
| 37      | B50-8901  | Body                      |
| 38      | B18-4101  | Anti-reverse lever        |
| 39      | B11-4301  | Anti-reverse lever spring |
| 40      | 353-8201  | Ball bearing screw        |
| 41      | B07-3301  | Bearing                   |
| 42      | B50-9401  | Drive gear                |
| 43      | 481-2401  | Oscillating slider        |
| 44      | 371-2800  | Drive gear washer         |
| 45      | B07-3301  | Bearing                   |
| 46      | B50-9801  | Body cover                |
| 47      | B51-0101  | Anti-reverse claw         |
| 48      | B50-1201  | Anti-reverse claw plate   |
| 49      | 351-6102  | Anti-reverse claw screw   |
| 50      | 351-5901  | Body cover screw          |
| 51      | B51-0201  | Handle                    |
| 52      | 363-4703  | Handle screw cap          |